

## Instructions of Networking Configuration for Data Logger (WiFi)

1. Open a wireless network.
2. Select logger network (network name: AP+SN) and connect. The password can be found on the logger label, which are the characters behind PWD.

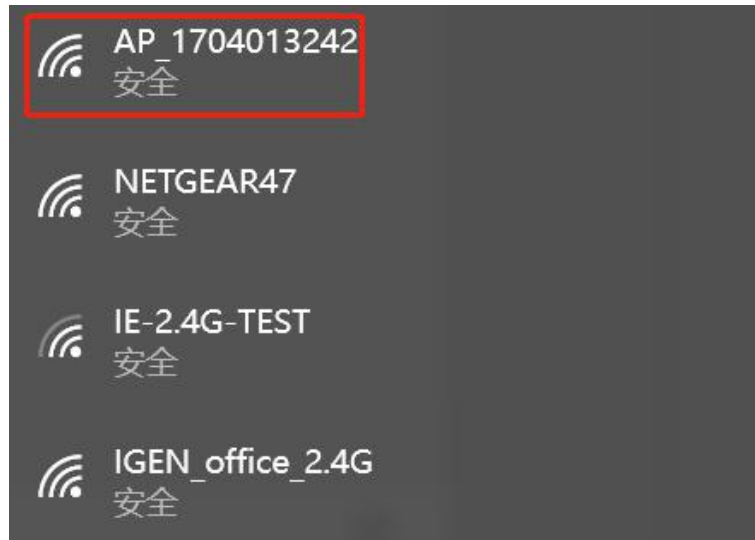

3. Open a browser and enter 10.10.100.254. Both username and password are admin. (Recommended browser: IE 8+, Chrome 15+, Firefox 10+.)

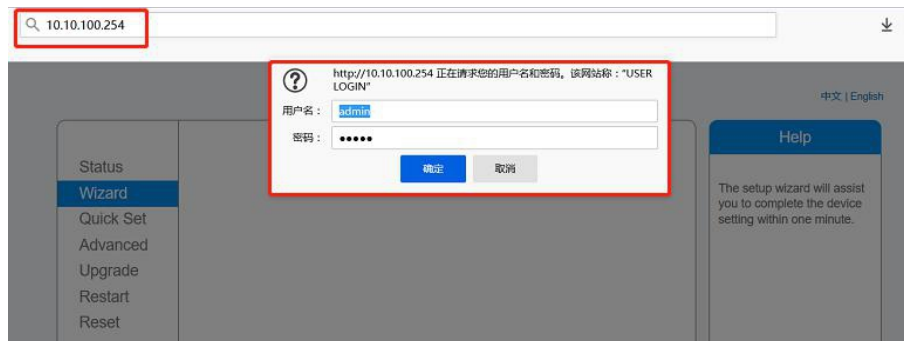

4. Go to logger setup page. The basic information are listed here.

中文 | English

Status	<div> <div>Inverter information</div> <table border="1"> <tr><td>Inverter serial number</td><td>---</td></tr> <tr><td>Firmware version (main)</td><td>---</td></tr> <tr><td>Firmware version (slave)</td><td>---</td></tr> <tr><td>Inverter model</td><td>---</td></tr> <tr><td>Rated power</td><td>--- W</td></tr> <tr><td>Current power</td><td>--- W</td></tr> <tr><td>Yield today</td><td>--- kWh</td></tr> <tr><td>Total yield</td><td>--- kWh</td></tr> <tr><td>Alerts</td><td>---</td></tr> <tr><td>Last updated</td><td>---</td></tr> </table> </div> <div> <div>Device information</div> <table border="1"> <tr><td>Device serial number</td><td>1704013242</td></tr> <tr><td>Firmware version</td><td>LSW3_14_FFFF_1.0.23</td></tr> <tr><td>Wireless AP mode</td><td>Enable</td></tr> <tr><td>SSID</td><td>AP_1704013242</td></tr> <tr><td>IP address</td><td>10.10.100.254</td></tr> <tr><td>MAC address</td><td>9C:D8:63:71:8D:B0</td></tr> <tr><td>Wireless STA mode</td><td>Disable</td></tr> <tr><td>Router SSID</td><td></td></tr> <tr><td>Signal Quality</td><td></td></tr> <tr><td>IP address</td><td></td></tr> <tr><td>MAC address</td><td></td></tr> </table> </div> <div> <div>Remote server information</div> <table border="1"> <tr><td>Remote server A</td><td>Not connected</td></tr> <tr><td>Remote server B</td><td>Not connected</td></tr> </table> </div>	Inverter serial number	---	Firmware version (main)	---	Firmware version (slave)	---	Inverter model	---	Rated power	--- W	Current power	--- W	Yield today	--- kWh	Total yield	--- kWh	Alerts	---	Last updated	---	Device serial number	1704013242	Firmware version	LSW3_14_FFFF_1.0.23	Wireless AP mode	Enable	SSID	AP_1704013242	IP address	10.10.100.254	MAC address	9C:D8:63:71:8D:B0	Wireless STA mode	Disable	Router SSID		Signal Quality		IP address		MAC address		Remote server A	Not connected	Remote server B	Not connected	<div>Help</div> <p>The device can be used as a wireless access point (AP mode) to facilitate users to configure the device, or it can also be used as a wireless information terminal (STA mode) to connect the remote server via wireless router.</p> <p><b>Status of remote server</b></p> <p>•Not connected: Connection to server failed last time. If under such status, please check the issues as follows: (1) check the device information to see whether IP address is obtained or not; (2) check if the router is connected to internet or not; (3) check if a firewall is set on the router or not;</p> <p>•Connected: Connection to server successful last time;</p> <p>•Unknown: No connection to server. Please check again in 5 minutes.</p>
Inverter serial number	---																																															
Firmware version (main)	---																																															
Firmware version (slave)	---																																															
Inverter model	---																																															
Rated power	--- W																																															
Current power	--- W																																															
Yield today	--- kWh																																															
Total yield	--- kWh																																															
Alerts	---																																															
Last updated	---																																															
Device serial number	1704013242																																															
Firmware version	LSW3_14_FFFF_1.0.23																																															
Wireless AP mode	Enable																																															
SSID	AP_1704013242																																															
IP address	10.10.100.254																																															
MAC address	9C:D8:63:71:8D:B0																																															
Wireless STA mode	Disable																																															
Router SSID																																																
Signal Quality																																																
IP address																																																
MAC address																																																
Remote server A	Not connected																																															
Remote server B	Not connected																																															

Web Ver:1.0.24

5. Go to setup guide, click Refresh to search the wireless network. Select the target network and connect.

Status	Wizard	<div>Quick Set</div> <div>Advanced</div> <div>Upgrade</div> <div>Restart</div> <div>Reset</div>	<div>Help</div> <p>The setup wizard will assist you to complete the device setting within one minute.</p>																																																										
<div> <div>Please select your current wireless network:</div> <table border="1"> <tr><td><input checked="" type="radio"/> IE-2.4G-TEST</td><td>54:A7:3:70:99:13</td><td>82</td><td>1</td></tr> <tr><td><input type="radio"/> AP_1753738492</td><td>0:BE:D5:20:B8:2C</td><td>80</td><td>1</td></tr> <tr><td><input type="radio"/> IGEN_office_2.4G</td><td>30:EA:E7:36:B:36</td><td>78</td><td>2</td></tr> <tr><td><input type="radio"/> IGENTEST</td><td>0:BE:D5:20:B8:2A</td><td>76</td><td>1</td></tr> <tr><td><input type="radio"/></td><td>E8:65:D4:F2:15:B8</td><td>74</td><td>6</td></tr> <tr><td><input type="radio"/></td><td>90:5D:7C:97:95:29</td><td>74</td><td>1</td></tr> <tr><td><input type="radio"/> IGEN_office_2.4G</td><td>90:5D:7C:97:95:27</td><td>72</td><td>1</td></tr> <tr><td><input type="radio"/></td><td>90:5D:7C:97:C9:E5</td><td>72</td><td>1</td></tr> <tr><td><input type="radio"/> AP_1719065936</td><td>30:EA:E7:36:CF:B2</td><td>70</td><td>1</td></tr> <tr><td><input type="radio"/> IGEN_office_2.4G</td><td>90:5D:7C:97:C9:E3</td><td>70</td><td>1</td></tr> <tr><td><input type="radio"/> TEST+"" ? = , ;</td><td>4A:E:EC:9E:C3:3E</td><td>70</td><td>11</td></tr> <tr><td><input type="radio"/> IGEN_office_2.4G</td><td>0:BE:D5:20:B7:EE</td><td>66</td><td>11</td></tr> <tr><td><input type="radio"/> AD_647075665</td><td>08:00:00:00:00:00</td><td>00</td><td>0</td></tr> </table> <p>*Note: When RSSI of the selected WiFi network is lower than 15%, the connection may be unstable, please select other available network or shorten the distance between the device and router.</p> <div>Refresh</div> </div> <div> <div>Add wireless network manually:</div> <table border="1"> <tr><td>Network name (SSID) (Note: case sensitive)</td><td>IE-2.4G-TEST</td></tr> <tr><td>Encryption method</td><td>WPA2PSK</td></tr> <tr><td>Encryption algorithm</td><td>AES</td></tr> </table> <div>Next</div> </div> <div> <div>1</div> <div>2</div> <div>3</div> <div>4</div> </div>				<input checked="" type="radio"/> IE-2.4G-TEST	54:A7:3:70:99:13	82	1	<input type="radio"/> AP_1753738492	0:BE:D5:20:B8:2C	80	1	<input type="radio"/> IGEN_office_2.4G	30:EA:E7:36:B:36	78	2	<input type="radio"/> IGENTEST	0:BE:D5:20:B8:2A	76	1	<input type="radio"/>	E8:65:D4:F2:15:B8	74	6	<input type="radio"/>	90:5D:7C:97:95:29	74	1	<input type="radio"/> IGEN_office_2.4G	90:5D:7C:97:95:27	72	1	<input type="radio"/>	90:5D:7C:97:C9:E5	72	1	<input type="radio"/> AP_1719065936	30:EA:E7:36:CF:B2	70	1	<input type="radio"/> IGEN_office_2.4G	90:5D:7C:97:C9:E3	70	1	<input type="radio"/> TEST+"" ? = , ;	4A:E:EC:9E:C3:3E	70	11	<input type="radio"/> IGEN_office_2.4G	0:BE:D5:20:B7:EE	66	11	<input type="radio"/> AD_647075665	08:00:00:00:00:00	00	0	Network name (SSID) (Note: case sensitive)	IE-2.4G-TEST	Encryption method	WPA2PSK	Encryption algorithm	AES
<input checked="" type="radio"/> IE-2.4G-TEST	54:A7:3:70:99:13	82	1																																																										
<input type="radio"/> AP_1753738492	0:BE:D5:20:B8:2C	80	1																																																										
<input type="radio"/> IGEN_office_2.4G	30:EA:E7:36:B:36	78	2																																																										
<input type="radio"/> IGENTEST	0:BE:D5:20:B8:2A	76	1																																																										
<input type="radio"/>	E8:65:D4:F2:15:B8	74	6																																																										
<input type="radio"/>	90:5D:7C:97:95:29	74	1																																																										
<input type="radio"/> IGEN_office_2.4G	90:5D:7C:97:95:27	72	1																																																										
<input type="radio"/>	90:5D:7C:97:C9:E5	72	1																																																										
<input type="radio"/> AP_1719065936	30:EA:E7:36:CF:B2	70	1																																																										
<input type="radio"/> IGEN_office_2.4G	90:5D:7C:97:C9:E3	70	1																																																										
<input type="radio"/> TEST+"" ? = , ;	4A:E:EC:9E:C3:3E	70	11																																																										
<input type="radio"/> IGEN_office_2.4G	0:BE:D5:20:B7:EE	66	11																																																										
<input type="radio"/> AD_647075665	08:00:00:00:00:00	00	0																																																										
Network name (SSID) (Note: case sensitive)	IE-2.4G-TEST																																																												
Encryption method	WPA2PSK																																																												
Encryption algorithm	AES																																																												

6. Enter the password and click Next.

中文 | English

Status  
**Wizard**  
Quick Set  
Advanced  
Upgrade  
Restart  
Reset

**Please fill in the following information:**

Password (8-64 bytes)  
(Note: case sensitive)

☐ Show Password

Obtain an IP address automatically Enable

IP address

Subnet mask

Gateway address

DNS server address

Back Next

1 2 3 4

**Help**

Most systems support the function of DHCP to obtain IP address automatically. Please select disable and add it manually if your router does not support such function.

Web Ver:1.0.24

7. Users can select any options below to enhance the security and click Next.

中文 | English

Status  
**Wizard**  
Quick Set  
Advanced  
Upgrade  
Restart  
Reset

**Enhance Security**

You can enhance your system security by choosing the following methods

☒ Hide AP

☐ Change the encryption mode for AP

☐ Change the user name and password for Web server

Back Next

1 2 3 4

**Help**

**Change the encryption mode for AP**  
If you set password for the AP network, you will need to enter the password to connect to AP.

**Change the user name and password for Web server**  
If you change the username and password for the web server, you will need to enter the new username and password to get access to the setting page.

Web Ver:1.0.24

8. If the setup is successful, the following page will pop up and click OK to reboot the module.

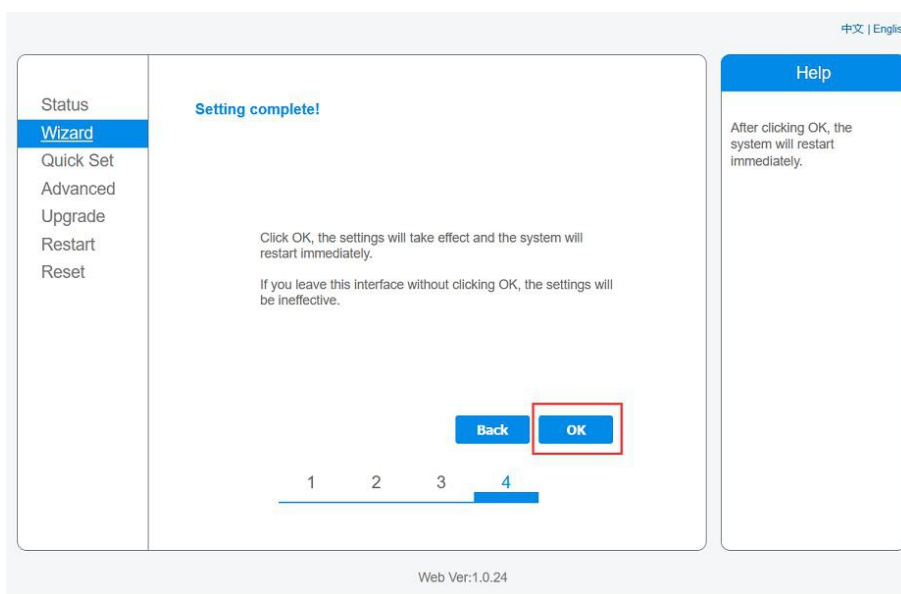

9. Log in to 10.10.100.254 again and check system info here.

After the network setting is done, wireless network STA mode is Enable. The info of router will be displayed on the page and the remote server A is connectable.

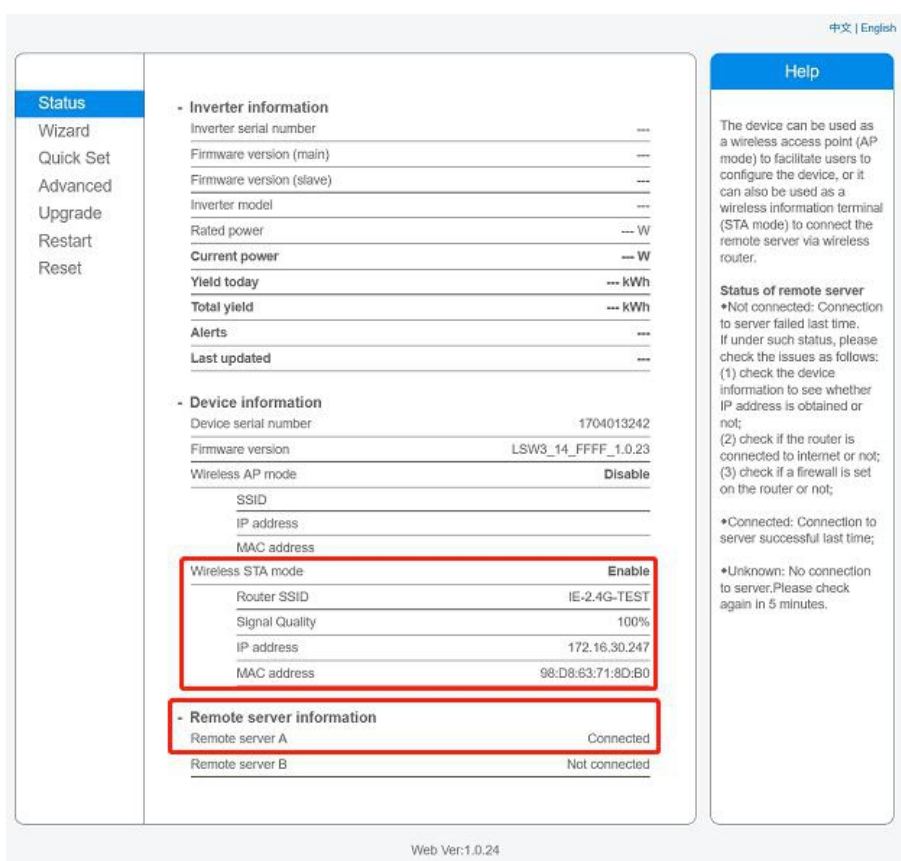

10. If the remote server is disconnectable, please refresh the page or try it again.